

17A

APPROVED
 WIDE LR. NO. 1/16615/92
 DTD 23-12-92
 P.P. NO. 168
 L.O. NO. 92

FOR MEMBER SECRETARY
 MADRAS METROPOLITAN
 DEVELOPMENT AUTHORITY

18/12/92

EXISTING BLDG.

Door No: 17

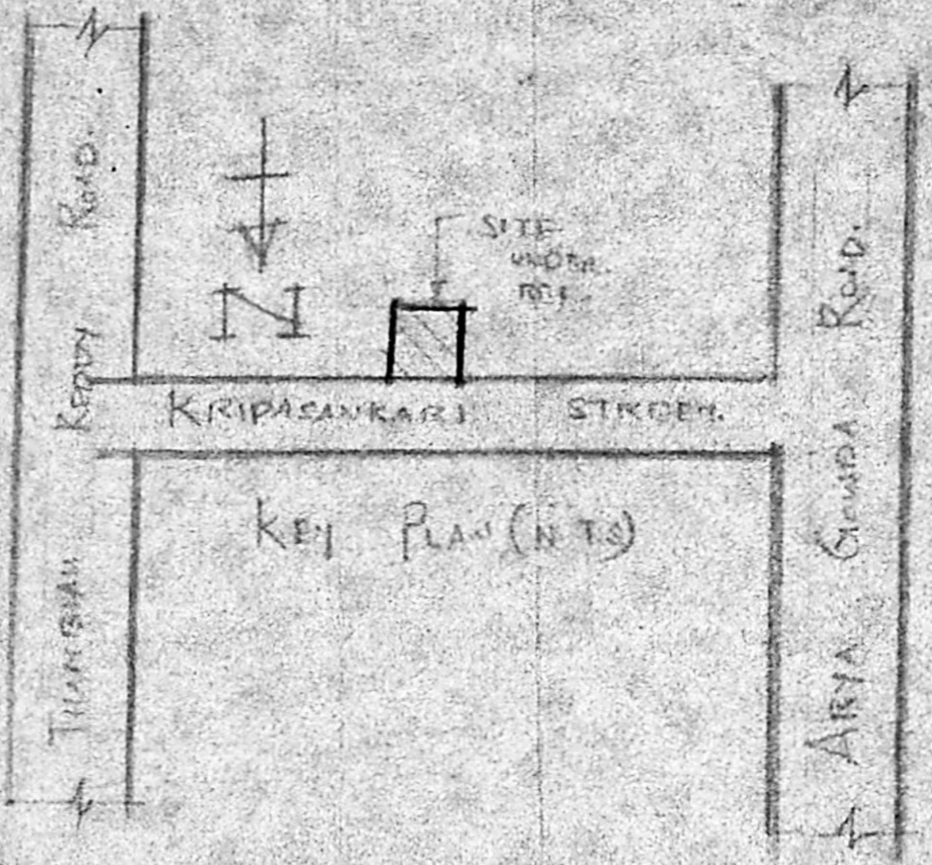

AREA STATEMENT -

Door No 17 - 1935 SFT OR 177.83 M²
 Door No 17A - 1527 SFT OR 141.84 M²
 PASSAGE - 426 SFT OR 39.03 M²
 TOTAL - 3888 SFT OR 360.70 M²

PLAN SHOWING PROPOSED SUB-DIVN
 AT DOOR No: 17, KRIPASANKARI STREET

NEXT MAMBALAM MADRAS

SCALE 1/100

REF:

PROPOSAL ROADS BOUNDARY

44' 3" (13.41)

27' 7" (8.46)

17' 3" (5.21)

(INNER)
 Anuraj Balavishwanathan

R. Mohan Rao, D.C.E.
 LICENSED SURVEYOR
 Corporation of Madras
 REG. No: 14
 AMBATTUR TOWNSHIP
 ALANDUR MUNICIPALITY
 Consulting Engineer
 Office: 15, Madhav Road
 T. NAGAR, MADRAS-600 017

PLAN.